

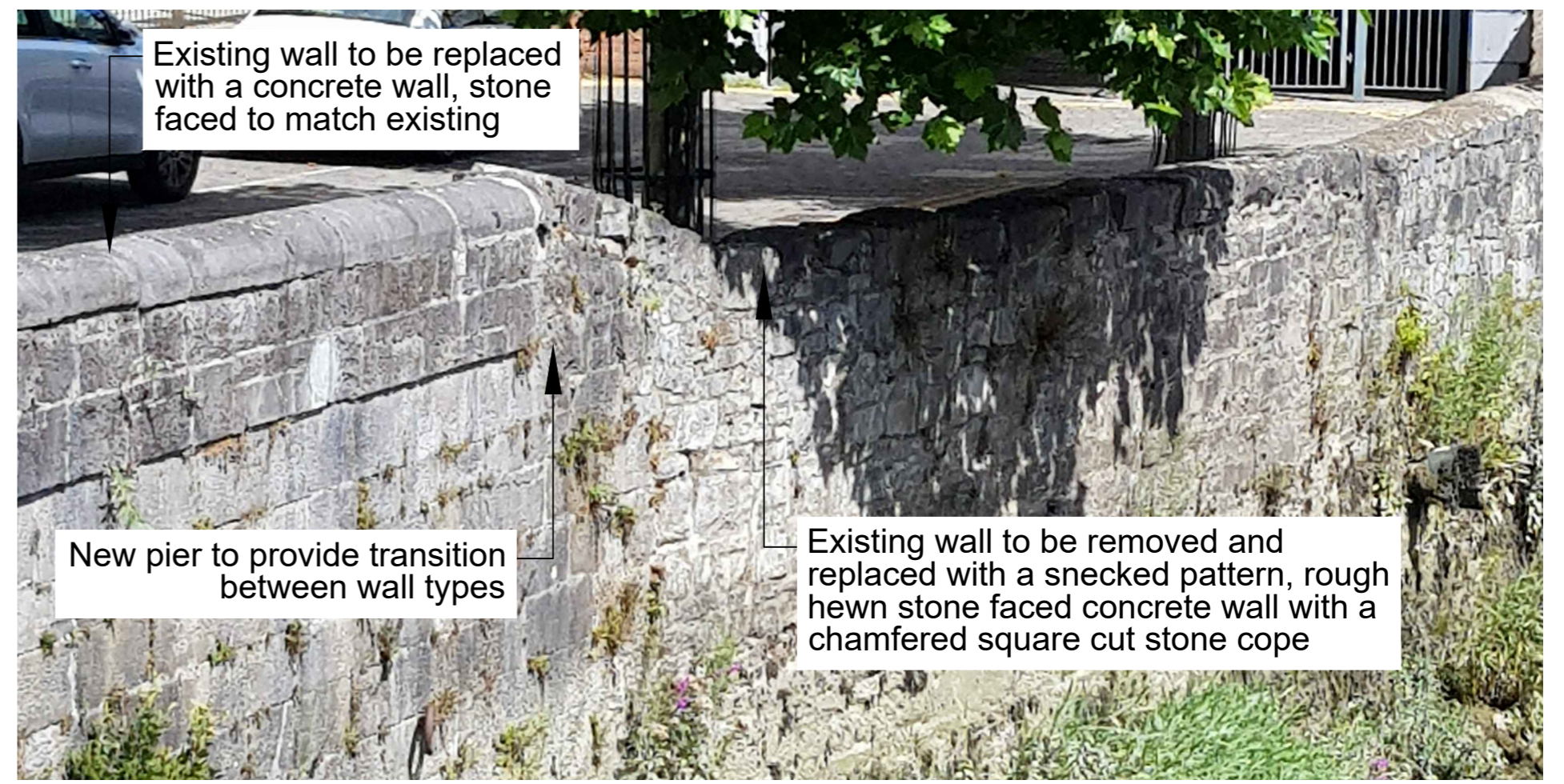

Wall treatment along the southern end of Sir Harry's Mall (KIFRS-A-009)



Wall treatment along the southern end of Sir Harry's Mall (KIFRS-A-009)



Example of glass flood defence panels

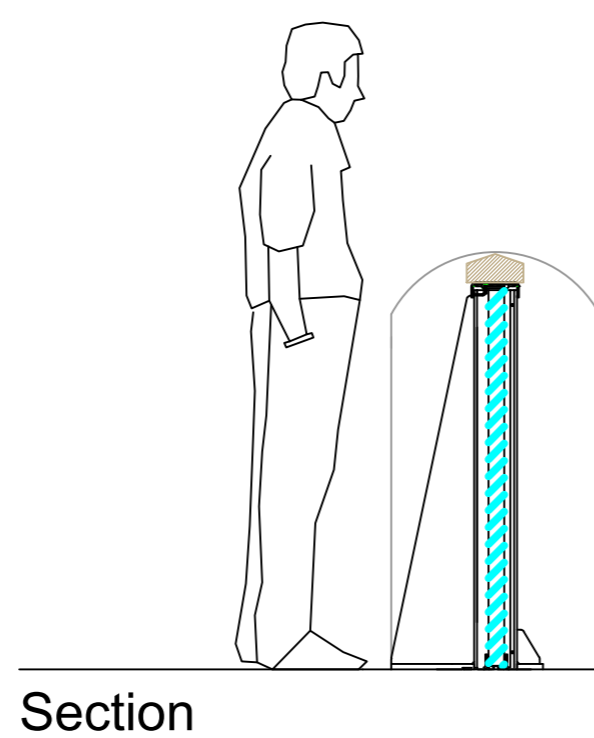

Section

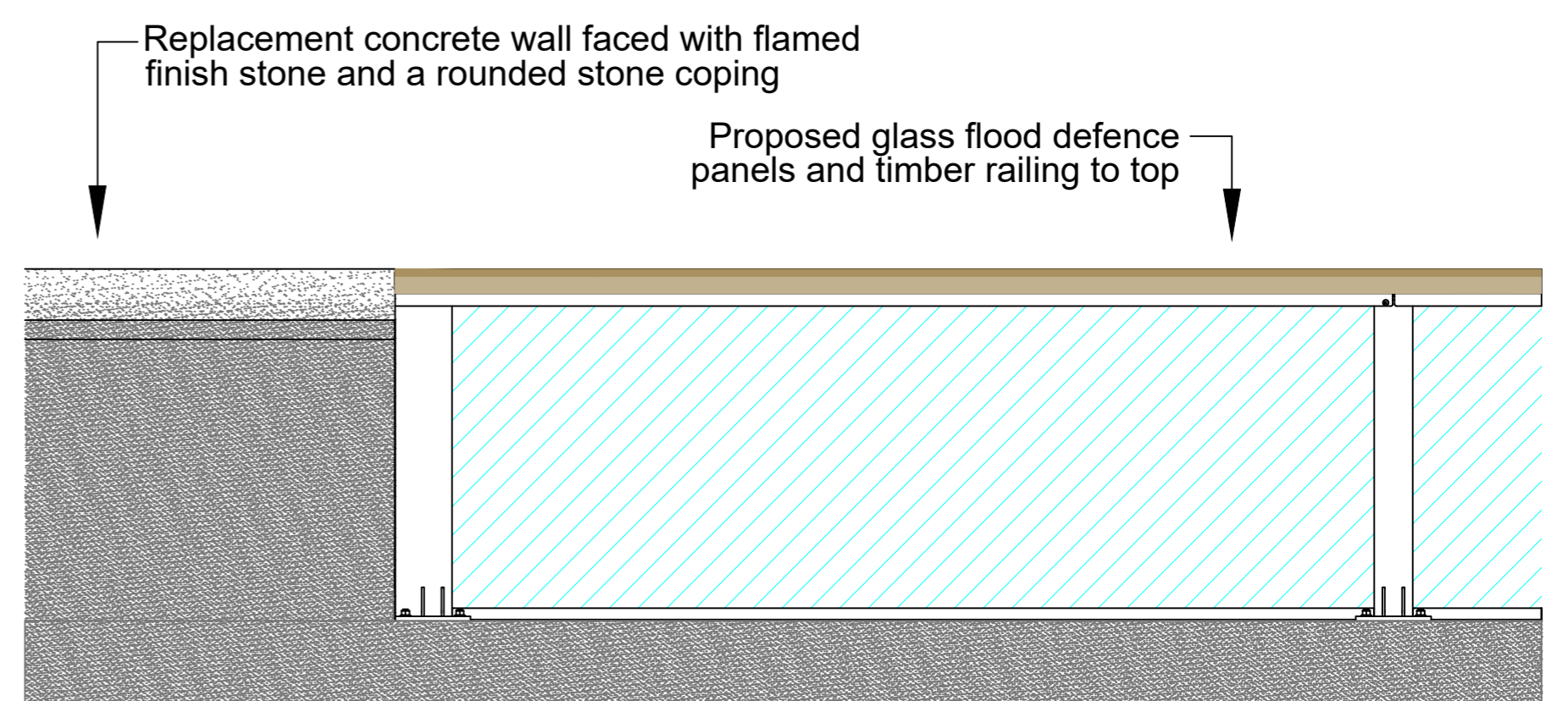

Elevation

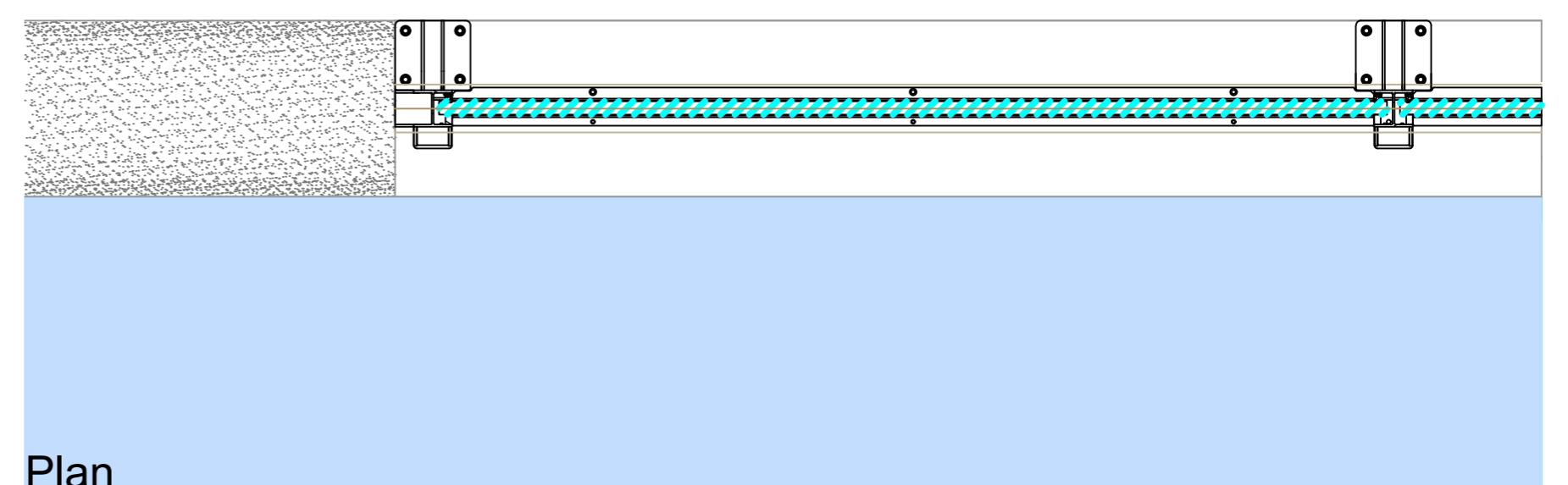

Plan

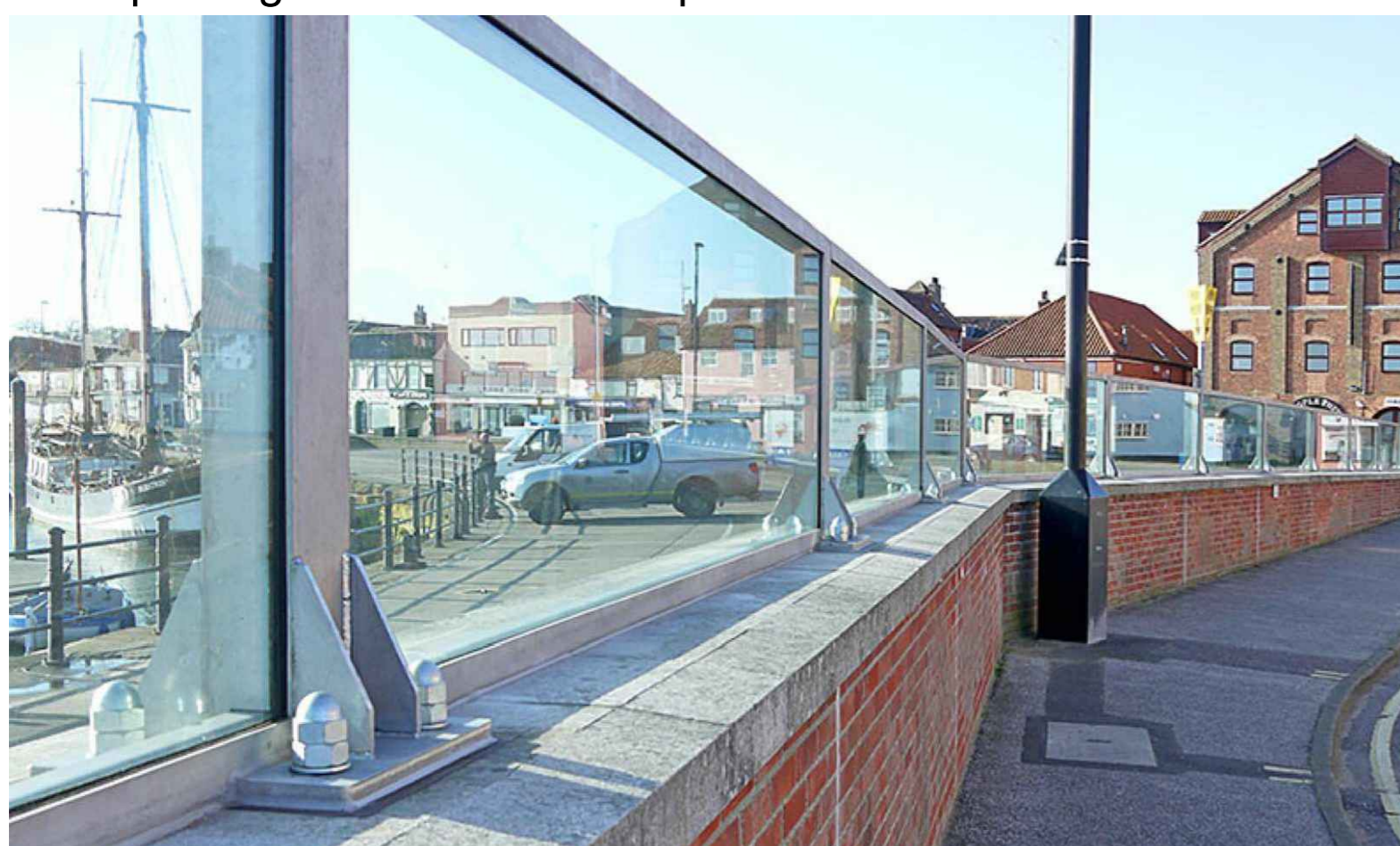

Glass flood defence panels to George's Quay and their interrelationship with the wall (KIFRS-A-010)



Existing quay edge railing south of King John's Castle (KIFRS-A-010)



Artists impression of proposed glass flood defence panels south of King John's Castle (KIFRS-A-010)